

TOWER CONNECTION

POSE	MATERIAL	WIDTH	LENGTH	QUALITY	PIECE	TOTAL PIECE
MBUD.BL08	MBUD.30M LADDER	0	0		1	1
MBUD.MC03		0	0		20	
DIN126-M12-STEEL-S		0	0	STEEL	2	
DIN127-M12-S-STEEL		0	0	S-STEEL	2	
DIN934-M12-6-STD-S		0	0	6	2	
YM-10	CB10.4	0	225	S235JR	1	
MBUD.AK04		0	0		1	
F-3B	PL2	500	2.000	S235JR	1	
F-4A	CB20	0	30	S235JR	2	
F-5	PL5	40	45	S235JR	1	
MBUD.AK03		0	0		1	
F-4	CB20	0	55	S235JR	2	
F-5	PL5	40	45	S235JR	1	
YM-1	L50x50x4	100	4.996	S235JR	2	
YM-8	CB16	0	340	S235JR	17	
MBUD.AK02		0	0		5	
YM-1	L50x50x4	100	4.996	S235JR	2	
YM-8	CB16	0	340	S235JR	17	
MBUD.CCB9		0	0		196	
DIN126-M12-STEEL-STD-SDG		0	0	STEEL	1	
DIN127-M12-S-STEEL-STD-SDG		0	0	S-STEEL	1	
DIN603-M12x40-5.8-STD-SDG		0	0	5.8	1	
DIN934-M12-6-STD-SDG		0	0	6	1	
MBUD.CCB1		0	0		6	
DIN126-M12-STEEL-STD-SDG		0	0	STEEL	1	
DIN127-M12-S-STEEL-STD-SDG		0	0	S-STEEL	1	
DIN933-M12x40-8.8-STD-SDG		0	0	8.8	1	
DIN934-M12-8-STD-SDG		0	0	8	1	
C-4A	PL4	40	824	S235JR	37	37
F-6B	PL2	1.004	2.000	S235JR	1	1
YM-2	FB40x4	0	2.540	S235JR	10	10
YM-6	FB40x4	0	1.640	S235JR	1	1
YM-9	FB40x4	0	204	S235JR	20	20
YM-9BS	PL6	50	212	S235JR	2	2

- GENERAL NOTES:
- All dimensions are in mm.
 - All members with "H" letter are of high tensile steel (S355JR)
 - All members without "H" letter are of standart steel (S235JR)
 - All bolts to be of high tensile steel (ISO 898/90)
 - Bolts DIN 603 , Plain Washers DIN 126. Nut DIN 934
 - All holes $\phi 13.5$ dia for M12 dia bolts
 ϕ All holes $\phi 17.5$ dia for M16 dia bolts
 ϕ All holes $\phi 21.5$ dia for M20 dia bolts
 - All steel items,bolts,nuts & washers to be hot-dip galvd.as per (ASTM-A-123-59)
 - All bolts are 8.8 quality

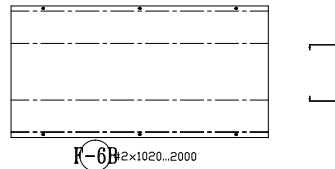
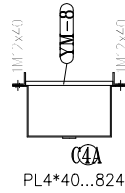
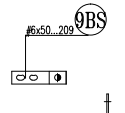
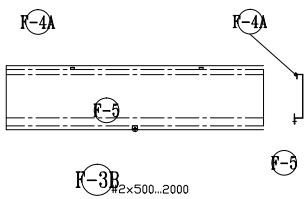

REVIZYON REVISION	D			
	C			
	B			
	A			
PROJE ADI PROJECT	30M LADDER TRIANGULAR TOWER			
MTS - MITAS TELEKOM SISTEM SANAYI TICARET A.S. SIRI GUMERNAK YOLU NO:13 GAZI 96500 ANKARA / TURKIYE P. +90 312 286 2000 - F. +90 312 286 2000 www.mtas.com.tr	HAZIRLAYAN DESIGNED BY	ÇİZEN DRAWN BY	KONTROL CHECKED BY	ONAY APPROVED BY
	HISIK	HISIK	MYILDIZ	SALPCAN
	ÖLÇEK SCALE	TARİH DATE	PAFTA NO DRAWING NO	REV.
	NTS	10.05.2016	MBUD-30M-LADDER	

POSE	MATERIAL	WIDTH	LENGTH	QUALITY	PIECE	TOTAL PIECE
MBUD.BL01	MBUD-30M TEMPLATE	0	0		1	1
MBUD.CG01		0	0		15	15
DIN126-M12-STEEL-STD-SDG		0	0	STEEL	1	15
DIN127-M12-S.STEEL-STD-SDG		0	0	S.STEEL	1	15
DIN933-M12X40-8.8-STD-SDG		0	0	8.8	1	15
DIN934-M12-8-STD-SDG		0	0	8	1	15
MBUD-T1	L60X60X5	120	1,777	S235JR	3	3
MBUD-T2	L50X50X5	100	1,040	S235JR	3	3
MBUD-T3	PL6	420	420	S235JR	3	3
MBUD.BL02	MBUD-30M ANCHORBOLT	0	0		1	1
MBUD.MG01		0	0		18	18
DIN126-M30-STEEL-S		0	0	STEEL	1	18
DIN127-M30-S.STEEL		0	0	S.STEEL	1	18
DIN934-M30-6-STD-S		0	0	6	5	90
MBUD-T5	CB27	0	1,200	ISO898Q6.8	1	18
MBUD-T4	PL6	420	420	S235JR	3	3

$\phi 27, \dots 1200$ 6.8 quality
 NUT 5M30 (DIN 555)
 P.W. A30 (DIN 126)
 S.W. A30 (DIN 127)

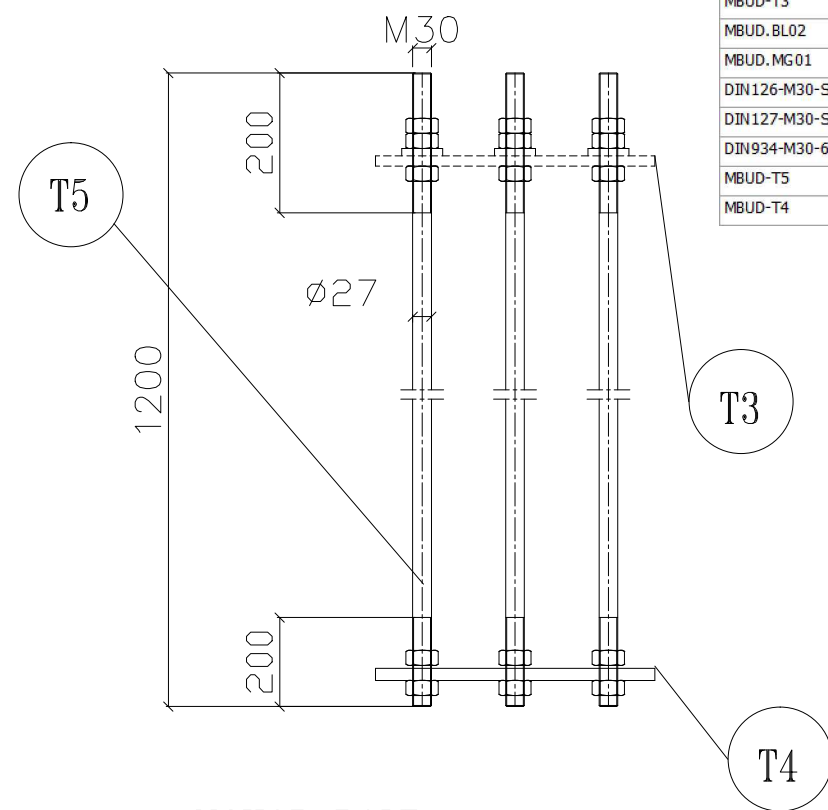
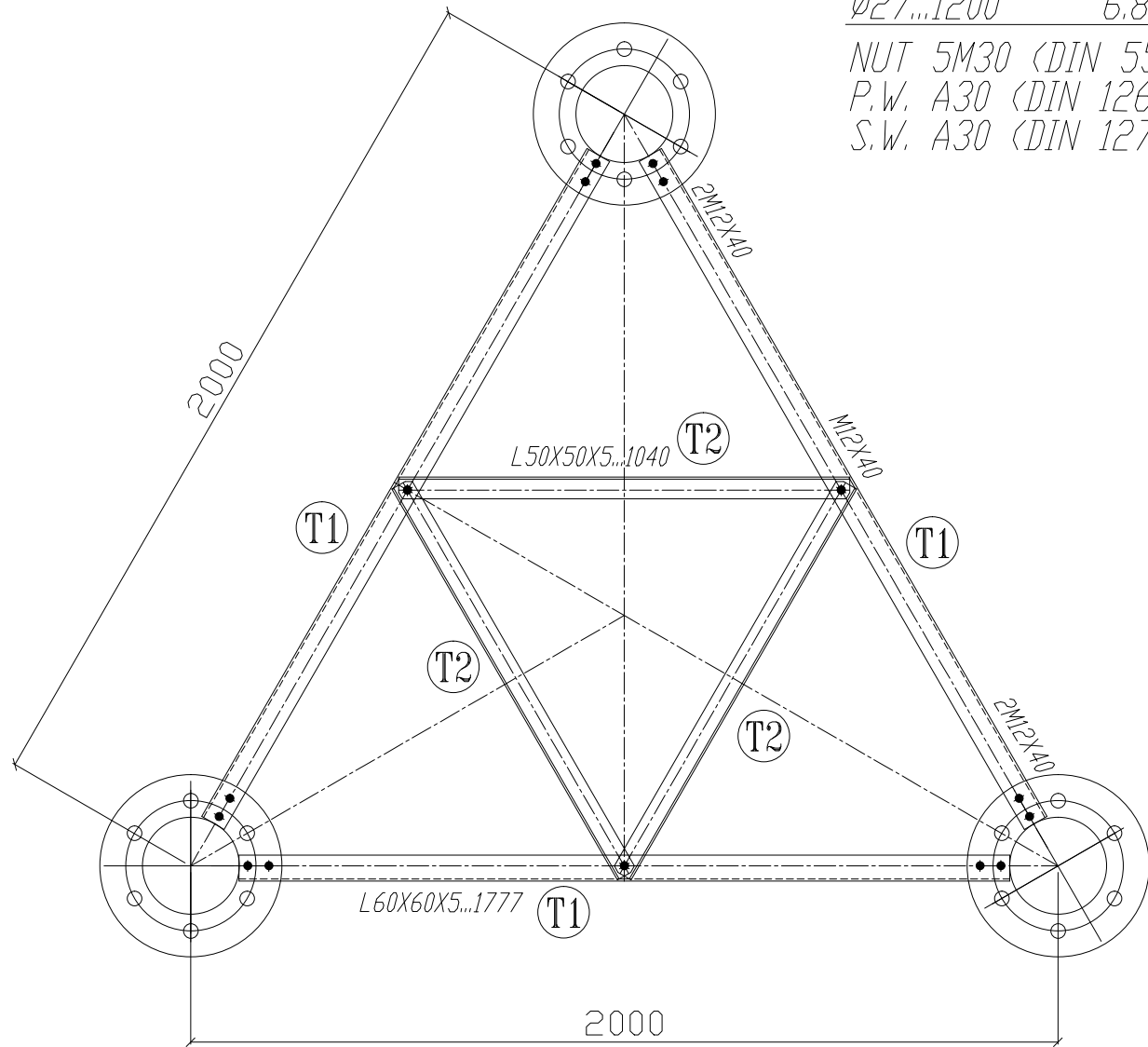

ANCHOR BOLT

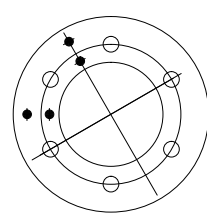

PL6X420X420
 HOLES 6X $\phi 32$
 HOLES 4X $\phi 13.5$

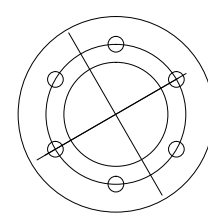

PL6X420X420
 HOLES 6X $\phi 32$

- GENERAL NOTES:
- All dimensions are in mm.
 - All members with "H" letter are of high tensile steel (S355JR)
 - All members without "H" letter are of standart steel (S235JR)
 - All bolts to be of high tensile steel (ISO 898/90)
 - Bolts DIN 933 , Plain Washers DIN 126. Nut DIN 934
 - All holes $\phi 13.5$ dia for M12 dia bolts
 - All holes $\phi 17.5$ dia for M16 dia bolts
 - All holes $\phi 21.5$ dia for M20 dia bolts
 - All steel items,bolts,nuts & washers to be hot-dip galvd.as per (ASTM-A-123-59)
 - All bolts are 8.8 quality

REVIZYON REVISION	D			
	C			
	B			
	A			
PROJE ADI PROJECT	30M TEMPLATE & ANCHORBOLT TRIANGULAR TOWER			
MTS - MITAS TELEKOM SISTEM MTS - MITAS TELEKOM SISTEM SANAYI TICARET A.S. ENK. GUMURNAK YOLU NO:13 GAZI OSKODU ANKARA / TURKIYE P: +90 312 286 2000 - F: +90 312 286 2009 www.mtsistem.com.tr - info@mtsistem.com.tr	HAZIRLAYAN DESIGNED BY	ÇİZEN DRAWN BY	KONTROL CHECKED BY	ONAY APPROVED BY
	HISK	HISK	MYILDIZ	SALPCAN
	ÖLÇEK SCALE	TARİH DATE	PAFTA NO DRAWING NO	REV. 0
	NTS	10.05.2016	MBUD-30M-TEMP	

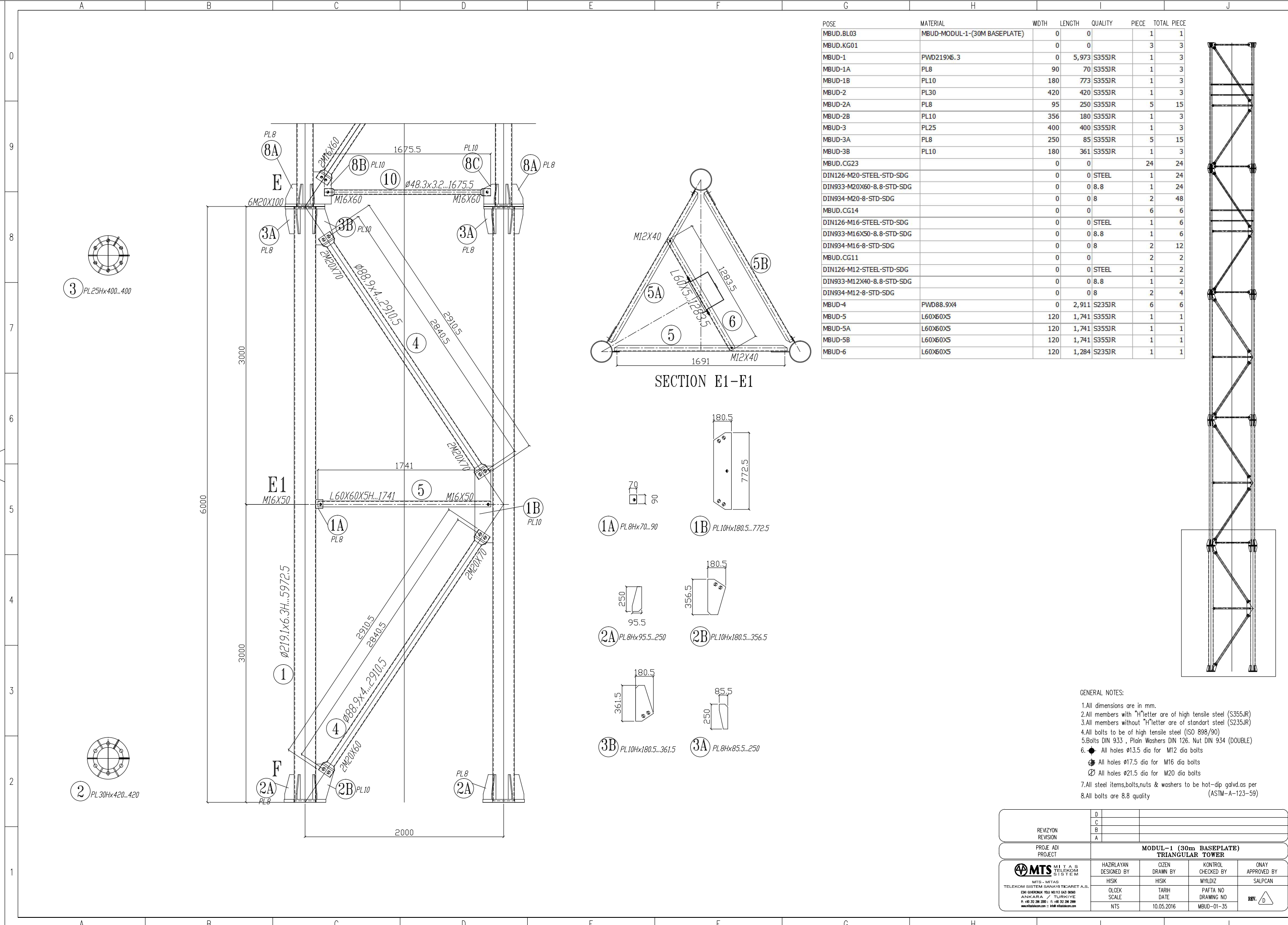

POSE	MATERIAL	WIDTH	LENGTH	QUALITY	PIECE	TOTAL PIECE
MBUD.BL03	MBUD-MODUL-1-(30M BASEPLATE)	0	0		1	1
MBUD.KG01		0	0		3	3
MBUD-1	PWD219X6.3	0	5,973	S355JR	1	3
MBUD-1A	PL8	90	70	S355JR	1	3
MBUD-1B	PL10	180	773	S355JR	1	3
MBUD-2	PL30	420	420	S355JR	1	3
MBUD-2A	PL8	95	250	S355JR	5	15
MBUD-2B	PL10	356	180	S355JR	1	3
MBUD-3	PL25	400	400	S355JR	1	3
MBUD-3A	PL8	250	85	S355JR	5	15
MBUD-3B	PL10	180	361	S355JR	1	3
MBUD.CG23		0	0		24	24
DIN126-M20-STEEL-STD-SDG		0	0	STEEL	1	24
DIN933-M20X60-8.8-STD-SDG		0	0	8.8	1	24
DIN934-M20-8-STD-SDG		0	0	8	2	48
MBUD.CG14		0	0		6	6
DIN126-M16-STEEL-STD-SDG		0	0	STEEL	1	6
DIN933-M16X50-8.8-STD-SDG		0	0	8.8	1	6
DIN934-M16-8-STD-SDG		0	0	8	2	12
MBUD.CG11		0	0		2	2
DIN126-M12-STEEL-STD-SDG		0	0	STEEL	1	2
DIN933-M12X40-8.8-STD-SDG		0	0	8.8	1	2
DIN934-M12-8-STD-SDG		0	0	8	2	4
MBUD-4	PWD88.9X4	0	2,911	S235JR	6	6
MBUD-5	L60X60X5	120	1,741	S355JR	1	1
MBUD-5A	L60X60X5	120	1,741	S355JR	1	1
MBUD-5B	L60X60X5	120	1,741	S355JR	1	1
MBUD-6	L60X60X5	120	1,284	S235JR	1	1

- GENERAL NOTES:
- All dimensions are in mm.
 - All members with "H" letter are of high tensile steel (S355JR)
 - All members without "H" letter are of standart steel (S235JR)
 - All bolts to be of high tensile steel (ISO 898/90)
 - Bolts DIN 933 , Plain Washers DIN 126. Nut DIN 934 (DOUBLE)
 - All holes $\phi 13.5$ dia for M12 dia bolts
 - All holes $\phi 17.5$ dia for M16 dia bolts
 - All holes $\phi 21.5$ dia for M20 dia bolts
 - All steel items,bolts,nuts & washers to be hot-dip galvd.as per (ASTM-A-123-59)
 - All bolts are 8.8 quality

REVIZYON REVISION	D			
	C			
	B			
	A			
PROJE ADI PROJECT	MODUL-1 (30m BASEPLATE) TRIANGULAR TOWER			
MTS - MITAS TELEKOM SISTEM SANAYI TICARET A.S. SIRI GUMERNAK YOLU NO:13 GAZI OSMAN ANKARA / TURKIYE P: +90 312 286 2000 - F: +90 312 286 2000 www.mtasistem.com.tr	HAZIRLAYAN DESIGNED BY	ÇİZEN DRAWN BY	KONTROL CHECKED BY	ONAY APPROVED BY
	HISIK	HISIK	MYILDIZ	SALPCAN
	ÖLÇEK SCALE	TARİH DATE	PAFTA NO DRAWING NO	REV.
	NTS	10.05.2016	MBUD-01-35	

POSE	MATERIAL	WIDTH	LENGTH	QUALITY	PIECE	TOTAL PIECE
MBUD.BL04	MBUD-MODUL-2-(REST PLT)	0	0		1	1
MBUD.KG07		0	0		1	1
MBUD-10A	PWD48.3X3.2	0	1,676	S235JR	1	1
MBUD-14	PL8	74	101	S235JR	1	1
MBUD.KG06		0	0		1	1
MBUD-10	PWD48.3X3.2	0	1,676	S235JR	1	1
MBUD-14	PL8	74	101	S235JR	1	1
MBUD.KG02		0	0		3	3
MBUD-7	PWD168.3X6	0	5,978	S355JR	1	3
MBUD-7A	PL8	90	70	S355JR	1	3
MBUD-7B	PL10	180	696	S355JR	1	3
MBUD-8	PL25	400	400	S355JR	1	3
MBUD-8A	PL8	200	111	S355JR	4	12
MBUD-8B	PL10	323	180	S355JR	1	3
MBUD-8C	PL10	200	116	S355JR	1	3
MBUD-9	PL20	320	320	S355JR	1	3
MBUD-9A	PL8	200	71	S355JR	5	15
MBUD-9B	PL10	328	180	S355JR	1	3
MBUD.CG15		0	0		30	30
DIN126-M16-STEEL-STD-SDG		0	0	STEEL	1	30
DIN933-M16X60-8.8-STD-SDG		0	0	8.8	1	30
DIN934-M16-8-STD-SDG		0	0	8	2	60
MBUD.CG12		0	0		2	2
DIN126-M12-STEEL-STD-SDG		0	0	STEEL	1	2
DIN933-M12X50-8.8-STD-SDG		0	0	8.8	1	2
DIN934-M12-8-STD-SDG		0	0	8	2	4
		0	0		2	2
DIN126-M20-STEEL-STD-SDG		0	0	STEEL	1	2
DIN933-M20X100-8.8-STD-SDG		0	0	8.8	1	2
DIN934-M20-8-STD-SDG		0	0	8	2	4
		0	0		18	18
DIN126-M20-STEEL-STD-SDG		0	0	STEEL	1	18
DIN933-M20X100-8.8-STD-SDG		0	0	8.8	1	18
DIN934-M20-8-STD-SDG		0	0	8	2	36
		0	0		6	6
DIN126-M16-STEEL-STD-SDG		0	0	STEEL	1	6
DIN933-M16X50-8.8-STD-SDG		0	0	8.8	1	6
DIN934-M16-8-STD-SDG		0	0	8	2	12
H101020		0	0		4	4
IZ-MBUD-15	SP225-34/38-3	1,136	513	S235JR	1	1
MBUD-10B	PWD48.3X3.2	0	1,676	S235JR	1	1
MBUD-11	PWD88.9X3.6	0	3,002	S235JR	6	6
MBUD-12	L60X60X5	120	1,792	S355JR	1	1
MBUD-12A	L60X60X5	120	1,792	S355JR	1	1
MBUD-12B	L60X60X5	120	1,792	S355JR	1	1
MBUD-13	L50X50X5	100	1,223	S235JR	1	1
MBUD-6	L60X60X5	120	1,284	S235JR	1	1

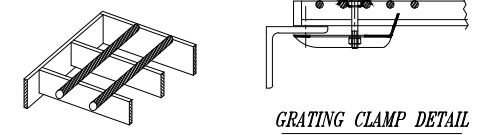
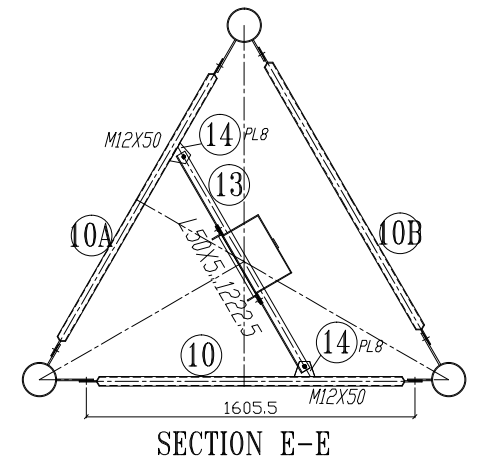
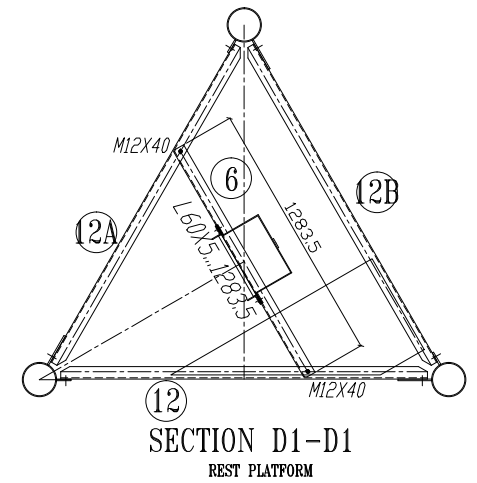
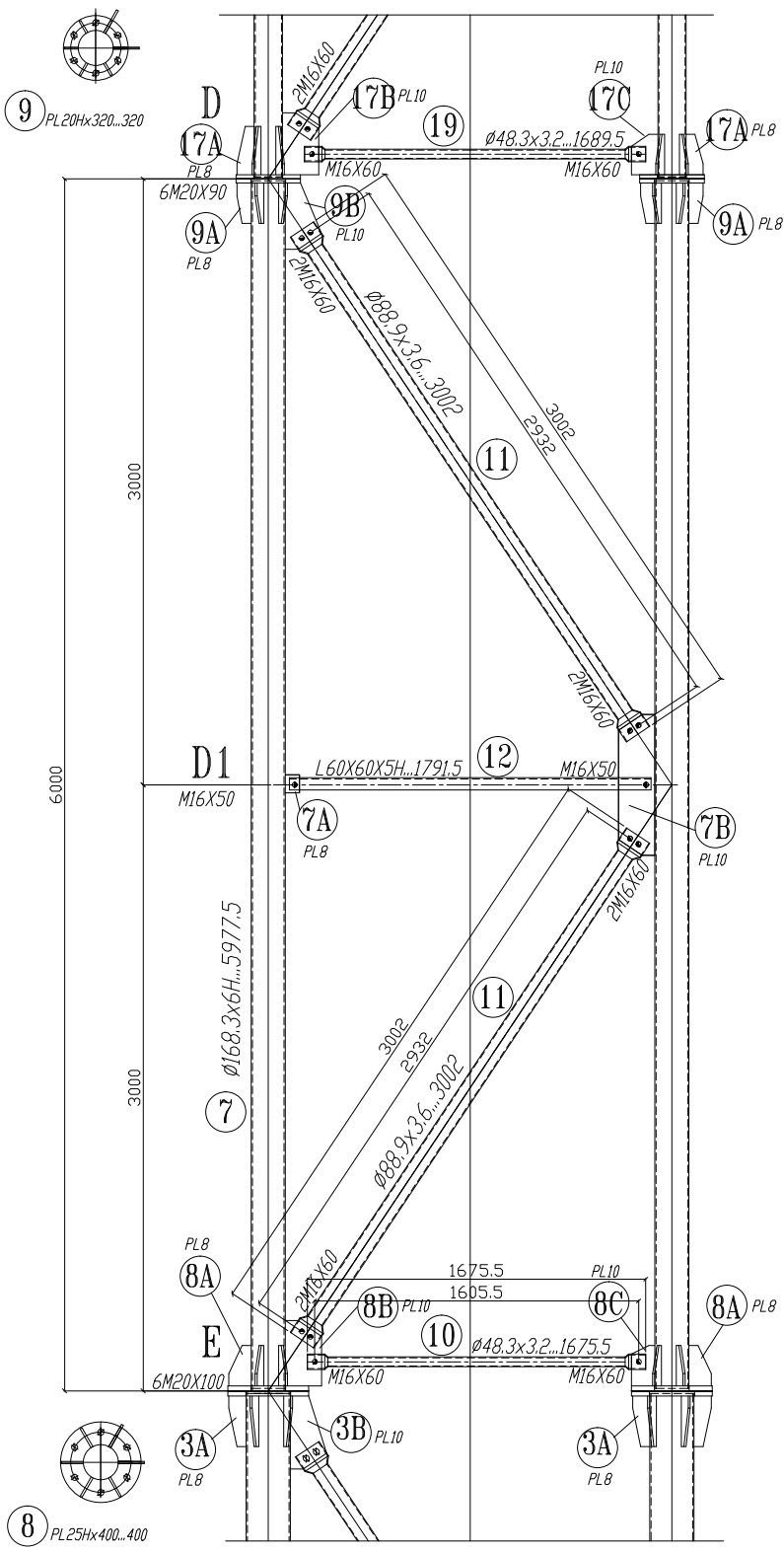
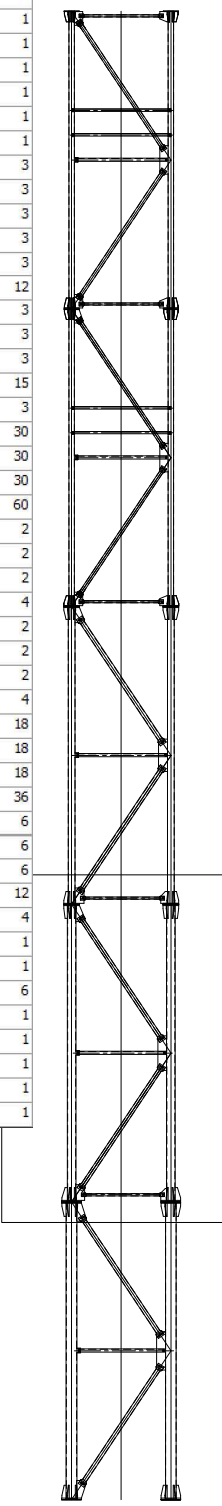

SP 225-34/38-3
GRATING-(DIN 24537)

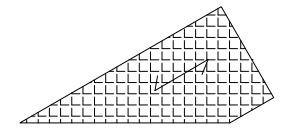

15 513X1135
225-34/38-3

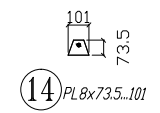

14 PL8x73.5...101

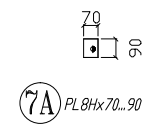

7A PL8x70...90

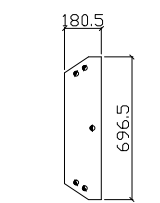

7B PL10x180.5...696.5

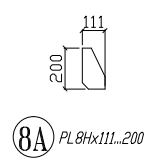

8A PL8x111...200

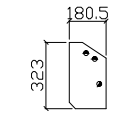

8B PL10x180.5...323

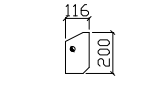

8C PL10x116...200



9A PL8x71...200

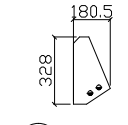

9B PL10x180.5...328

- GENERAL NOTES:
- All dimensions are in mm.
 - All members with "H" letter are of high tensile steel (S355JR)
 - All members without "H" letter are of standard steel (S235JR)
 - All bolts to be of high tensile steel (ISO 898/90)
 - Bolts DIN 933, Plain Washers DIN 126, Nut DIN 934 (DOUBLE)
 - All holes ϕ 13.5 dia for M12 dia bolts
 - All holes ϕ 17.5 dia for M16 dia bolts
 - All holes ϕ 21.5 dia for M20 dia bolts
 - All steel items, bolts, nuts & washers to be hot-dip galvd. as per (ASTM-A-123-59)
 - All bolts are 8.8 quality

REVIZYON REVISION	D			
	C			
PROJE ADI PROJECT	B			
	A			
M.T.A.S TELEKOM SİSTEM M.T.S. - M.T.A.S TELEKOM SİSTEM SANAYİ TİCARET A.Ş. Eski Büyükdere Yolu No:113 Gaz 90500 ANKARA / TÜRKİYE P: +90 312 286 2000 - F: +90 312 286 2000 www.mtsistem.com.tr - info@mtsistem.com.tr	HAZIRLAYAN DESIGNED BY	ÇİZEN DRAWN BY	KONTROL CHECKED BY	ONAY APPROVED BY
	HISK	HISK	MYILDIZ	SALPCAN
ÖLÇEK SCALE	TARİH DATE	PAFTA NO DRAWING NO		
NTS	10.05.2016	MBUD-02		

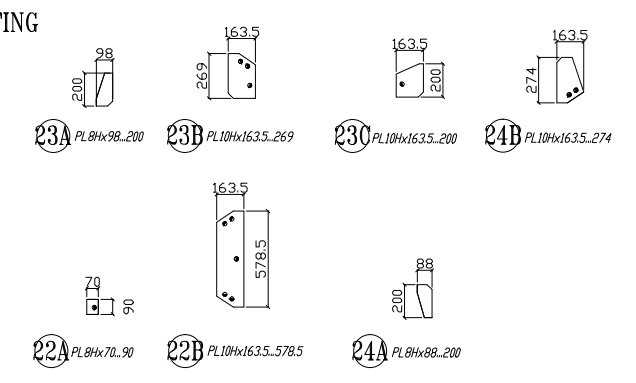
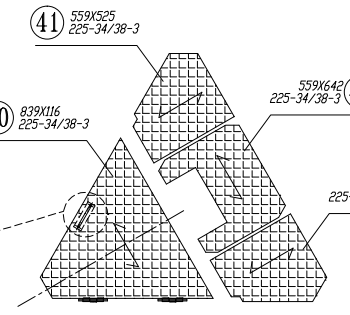
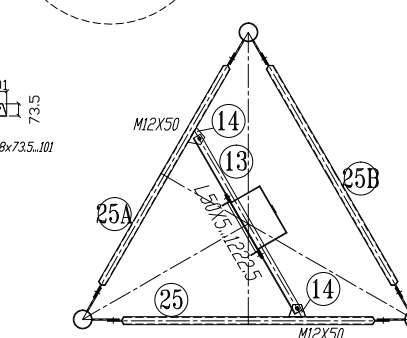
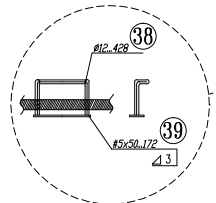
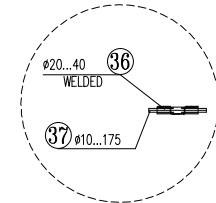
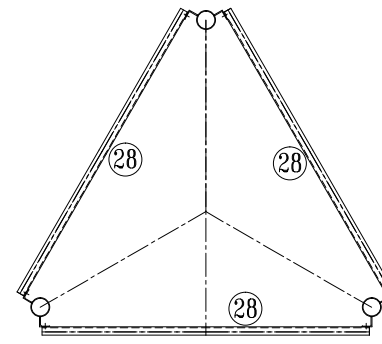
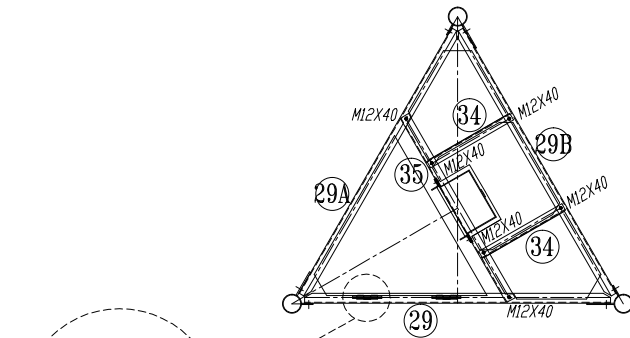
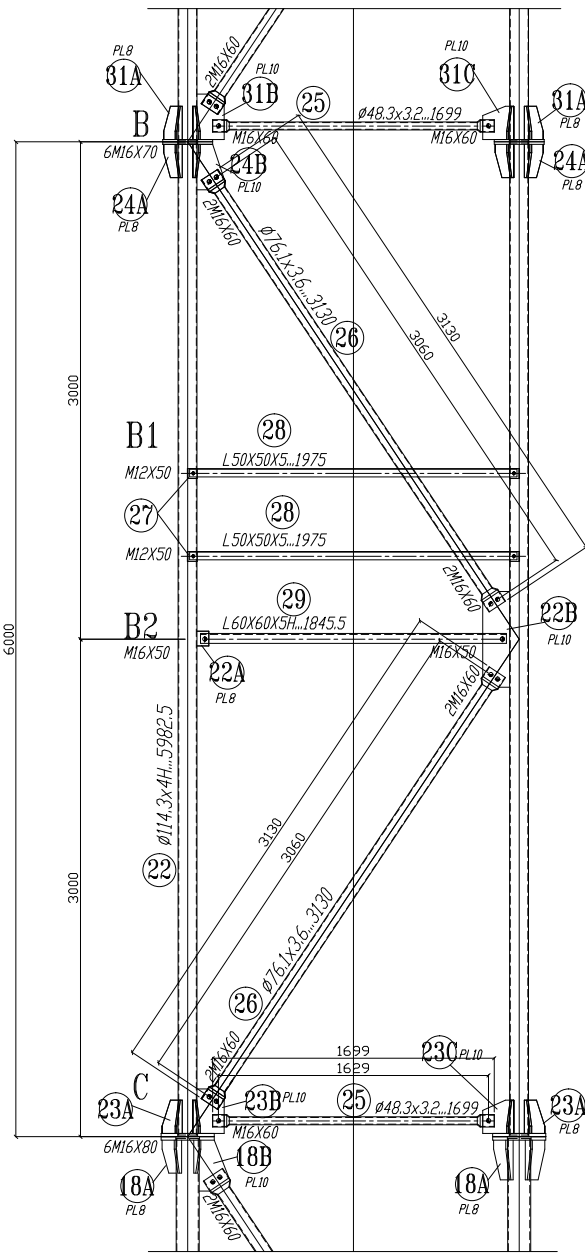

POSE	MATERIAL	WIDTH	LENGTH	QUALITY	PIECE	TOTAL PIECE
MBUD.BL06	MBUD-MODUL-4-(WORK PLT)	0	0		1	1
MBUD.NG12		0	0		1	1
MBUD-29	L60X60X5	120	1,846	S355JR	1	
MBUD-36	CB20	0	40	S235JR	2	
MBUD.NG11		0	0		1	1
MBUD-14	PL8	74	101	S235JR	1	
MBUD-25 A	PWD48.3X3.2	0	1,699	S235JR	1	
MBUD.NG10		0	0		1	1
MBUD-14	PL8	74	101	S235JR	1	
MBUD-25	PWD48.3X3.2	0	1,699	S235JR	1	
MBUD.NG04		0	0		3	3
MBUD-22	PWD114.3X4	0	5,983	S355JR	1	
MBUD-22 A	PL8	90	70	S355JR	1	
MBUD-22 B	PL10	163	578	S355JR	1	
MBUD-23	PL20	320	320	S355JR	1	
MBUD-23 A	PL8	98	200	S355JR	4	
MBUD-23 B	PL10	269	163	S355JR	1	
MBUD-23 C	PL10	163	200	S355JR	1	
MBUD-24	PL15	300	300	S355JR	1	
MBUD-24 A	PL8	200	88	S355JR	5	
MBUD-24 B	PL10	163	274	S355JR	1	
MBUD-27	L60X60X5	120	60	S235JR	4	
MBUD.AK01		0	0		1	1
IZ-MBUD-40	SP225-34/38-3	838	116	S235JR	1	
MBUD-36	CB20	0	40	S235JR	4	
MBUD-38	CB12	0	428	S235JR	1	
MBUD-39	FB50X5	0	172	S235JR	1	
MBUD.CG15		0	0		30	30
DIN1 26-M16-STEEL-STD-SDG		0	0	STEEL	1	
DIN9 33-M16X0-8-8-STD-SDG		0	0	8.8	1	
DIN9 34-M16-8-STD-SDG		0	0	8	2	
MBUD.CG14		0	0		6	6
DIN1 26-M16-STEEL-STD-SDG		0	0	STEEL	1	
DIN9 33-M16X0-8-8-STD-SDG		0	0	8.8	1	
DIN9 34-M16-8-STD-SDG		0	0	8	2	
MBUD.CG12		0	0		14	14
DIN1 26-M12-STEEL-STD-SDG		0	0	STEEL	1	
DIN9 33-M12X0-8-8-STD-SDG		0	0	8.8	1	
DIN9 34-M12-8-STD-SDG		0	0	8	2	
MBUD.CG11		0	0		6	6
DIN1 26-M12-STEEL-STD-SDG		0	0	STEEL	1	
DIN9 33-M12X0-8-8-STD-SDG		0	0	8.8	1	
DIN9 34-M12-8-STD-SDG		0	0	8	2	
MBUD.CG17		0	0		18	18
DIN1 26-M16-STEEL-STD-SDG		0	0	STEEL	1	
DIN9 33-M16X0-8-8-STD-SDG		0	0	8.8	1	
DIN9 34-M16-8-STD-SDG		0	0	8	2	
MBUD.CG08		0	0		2	2
DIN9 4-M8X32-STEEL-STD-SDG		0	0	STEEL	1	
MBUD.MG02		0	0		2	2
MBUD-37	CB10	0	175	S235JR	1	
HI01020		0	0		12	12
IZ-MBUD-41	SP225-34/38-3	559	525	S235JR	1	1
IZ-MBUD-42	SP225-34/38-3	559	525	S235JR	1	1
IZ-MBUD-43	SP225-34/38-3	642	559	S235JR	1	1
MBUD-13	L50X50X5	100	1,223	S235JR	1	1
MBUD-25 B	PWD48.3X3.2	0	1,699	S235JR	1	1
MBUD-26	PWD76.1X3.6	0	3,130	S235JR	6	6
MBUD-28	L50X50X5	100	1,975	S235JR	6	6
MBUD-29 A	L60X60X5	120	1,846	S355JR	1	1
MBUD-29 B	L60X60X5	120	1,846	S355JR	1	1
MBUD-34	L45X45X4	90	578	S235JR	2	2
MBUD-35	L60X60X5	120	1,283	S235JR	1	1

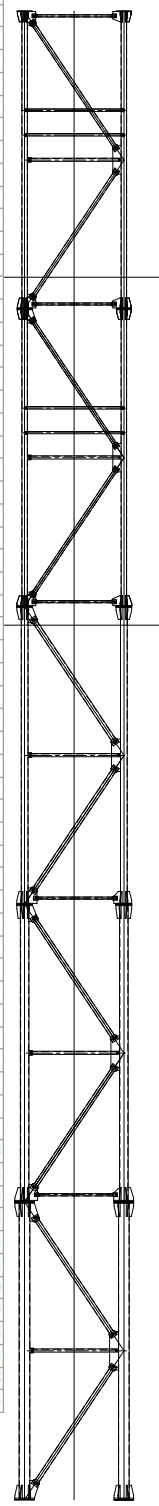

- GENERAL NOTES:
- All dimensions are in mm.
 - All members with "H" letter are of high tensile steel (S355JR)
 - All members without "H" letter are of standart steel (S235JR)
 - All bolts to be of high tensile steel (ISO 898/90)
 - Bolts DIN 933 , Plain Washers DIN 126. Nut DIN 934 (DOUBLE)
 - All holes $\phi 13.5$ dia for M12 dia bolts
 - All holes $\phi 17.5$ dia for M16 dia bolts
 - All holes $\phi 21.5$ dia for M20 dia bolts
 - All steel items,bolts,nuts & washers to be hot-dip galvd.as per (ASTM-A-123-59)
 - All bolts are 8.8 quality

REVIZYON REVISION	D			
	C			
PROJE ADI PROJECT	B			
	A			
 MTS - MITAS TELEKOM SISTEM SANAYI TICARET A.S. DSK GUMERNAK YOLU NO:13 GAZI OSMAN ANKARA / TURKIYE P. +90 312 286 2000 - F. +90 312 286 2000 www.mtasistem.com.tr - info@mtasistem.com.tr	MODUL-4 (WORK PLATFORM) TRIANGULAR TOWER			
	HAZIRLAYAN DESIGNED BY	ÇİZEN DRAWN BY	KONTROL CHECKED BY	ONAY APPROVED BY
	HISIK	HISIK	MYILDIZ	SALPCAN
	ÖLÇEK SCALE	TARİH DATE	PAFTA NO DRAWING NO	REV. 0
	NTS	10.05.2016	MBUD-04	

POSE	MATERIAL	WIDTH	LENGTH	QUALITY	PIECE	TOTAL PIECE
MBUD.BL07	MBUD-MODUL-5-(WORK PLT)	0	0		1	1
MBUD.AK01		0	0		1	
IZ-MBUD-40	SP225-34/38-3	838	116	S235JR	1	
MBUD-36	CB20	0	40	S235JR	4	
MBUD-38	CB12	0	428	S235JR	1	
MBUD-39	FB50X5	0	172	S235JR	1	
MBUD.MG02		0	0		2	
MBUD-37	CB10	0	175	S235JR	1	
MBUD.KG12		0	0		1	
MBUD-29	L60X60X5	120	1,846	S355JR	1	
MBUD-36	CB20	0	40	S235JR	2	
MBUD.KG11		0	0		2	
MBUD-14	PL8	74	101	S235JR	1	
MBUD-25A	PWD48.3X3.2	0	1,699	S235JR	1	
MBUD.KG10		0	0		2	
MBUD-14	PL8	74	101	S235JR	1	
MBUD-25	PWD48.3X3.2	0	1,699	S235JR	1	
MBUD.KG05		0	0		3	
MBUD-27	L60X60X5	120	60	S235JR	4	
MBUD-30	PWD114.3X3.6	0	5,985	S355JR	1	
MBUD-30A	PL8	90	70	S355JR	1	
MBUD-30B	PL10	163	578	S355JR	1	
MBUD-31	PL15	300	300	S355JR	1	
MBUD-31A	PL8	88	200	S355JR	4	
MBUD-31B	PL10	274	163	S355JR	1	
MBUD-31C	PL10	163	200	S355JR	1	
MBUD-32	PL15	300	300	S355JR	1	
MBUD-32A	PL8	200	88	S355JR	4	
MBUD-32B	PL10	274	163	S355JR	1	
MBUD-32C	PL10	200	163	S355JR	1	
MBUD.CG16		0	0		18	
DIN126-M16-STEEL-STD-SDG		0	0	STEEL	1	
DIN933-M16X70-8.8-STD-SDG		0	0	8.8	1	
DIN934-M16-8-STD-SDG		0	0	8	2	
MBUD.CG15		0	0		54	
DIN126-M16-STEEL-STD-SDG		0	0	STEEL	1	
DIN933-M16X60-8.8-STD-SDG		0	0	8.8	1	
DIN934-M16-8-STD-SDG		0	0	8	2	
MBUD.CG14		0	0		6	
DIN126-M16-STEEL-STD-SDG		0	0	STEEL	1	
DIN933-M16X50-8.8-STD-SDG		0	0	8.8	1	
DIN934-M16-8-STD-SDG		0	0	8	2	
MBUD.CG12		0	0		14	
DIN126-M12-STEEL-STD-SDG		0	0	STEEL	1	
DIN933-M12X50-8.8-STD-SDG		0	0	8.8	1	
DIN934-M12-8-STD-SDG		0	0	8	2	
MBUD.CG11		0	0		6	
DIN126-M12-STEEL-STD-SDG		0	0	STEEL	1	
DIN933-M12X40-8.8-STD-SDG		0	0	8.8	1	
DIN934-M12-8-STD-SDG		0	0	8	2	
MBUD.CG08		0	0		4	
DIN94-M3X32-STEEL-STD-SDG		0	0	STEEL	1	
H101020		0	0		12	12
IZ-MBUD-41	SP225-34/38-3	559	525	S235JR	1	1
IZ-MBUD-42	SP225-34/38-3	559	525	S235JR	1	1
IZ-MBUD-43	SP225-34/38-3	642	599	S235JR	1	1
MBUD-13	L50X50X5	100	1,225	S235JR	2	1
MBUD-25B	PWD48.3X3.2	0	1,699	S235JR	2	1
MBUD-26	PWD76.1X3.6	0	3,130	S235JR	6	6
MBUD-28	L50X50X5	100	1,975	S235JR	6	6
MBUD-29A	L60X60X5	120	1,846	S355JR	1	1
MBUD-29B	L60X60X5	120	1,846	S355JR	1	1
MBUD-33	PL3	300	300	S235JR	3	3
MBUD-34	L45X45X4	90	578	S235JR	2	2
MBUD-35	L60X60X5	120	1,283	S235JR	1	1

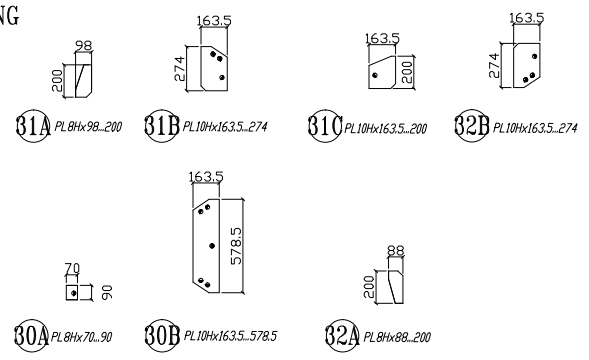
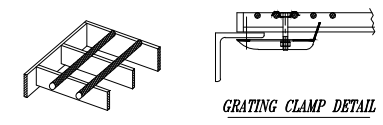
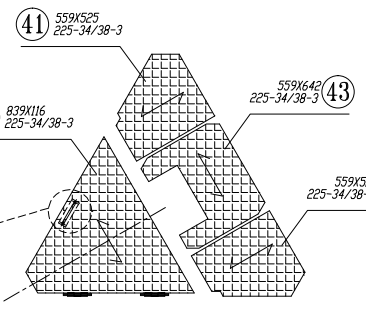
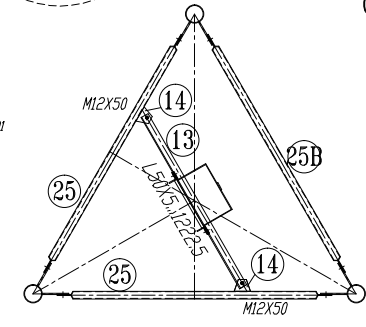
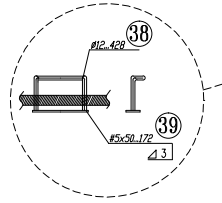
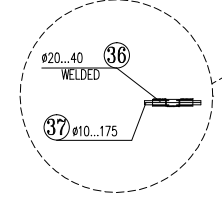
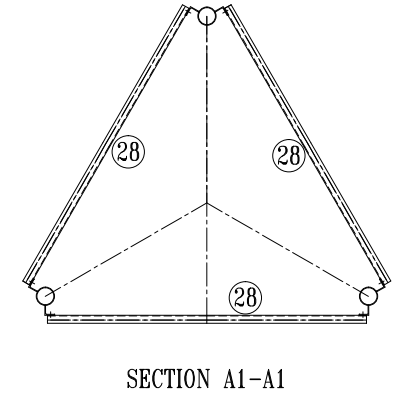
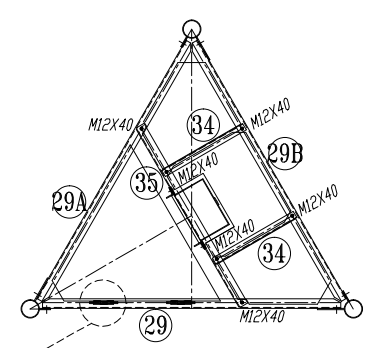
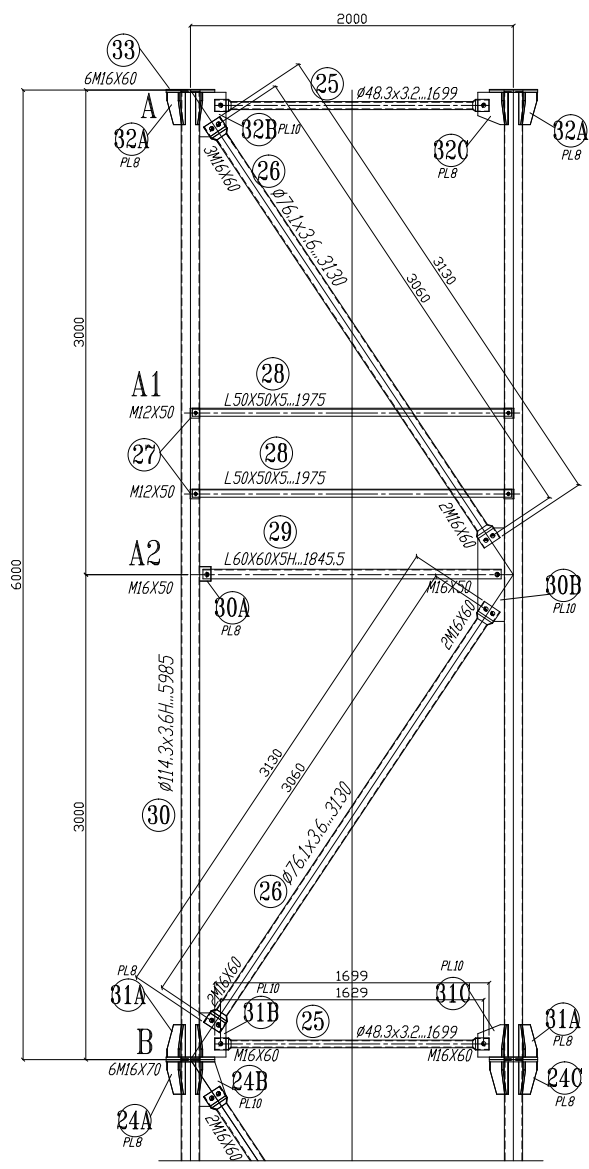
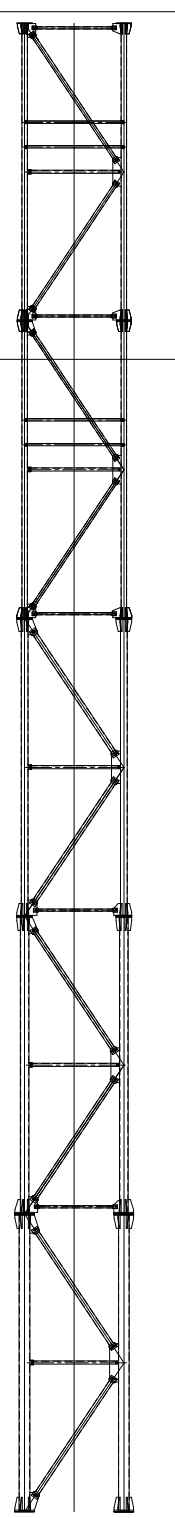

- GENERAL NOTES:
- All dimensions are in mm.
 - All members with "H" letter are of high tensile steel (S355JR)
 - All members without "H" letter are of standard steel (S235JR)
 - All bolts to be of high tensile steel (ISO 898/90)
 - Bolts DIN 933, Plain Washers DIN 126. Nut DIN 934 (DOUBLE)
 - All holes $\phi 13.5$ dia for M12 dia bolts
 - All holes $\phi 17.5$ dia for M16 dia bolts
 - All holes $\phi 21.5$ dia for M20 dia bolts
 - All steel items, bolts, nuts & washers to be hot-dip galv. as per (ASTM-A-123-59)
 - All bolts are 8.8 quality

REVIZYON	D			
	C			
PROJE ADI	B			
	A			
PROJECT	MODUL-5 (WORK PLATFORM) TRIANGULAR TOWER			
HAZIRLAYAN	HAZIRLAYAN	ÇİZEN	KONTROL	ONAY
	DESIGNED BY	DRAWN BY	CHECKED BY	APPROVED BY
OLÇEK	HISK	HISK	MYILDIZ	SALPCAN
	SCALE	TARİH	PAFTA NO	
NTS	DATE	DRAWING NO		
	NTS	10.05.2016	MBUD-05	

MTS MİTAS TELEKOM SİSTEM
 MTS - MITAS TELEKOM SİSTEM SANAYİ TİCARİET A.Ş.
 İSKİ GÜZERBAK YOLU NO:13 GAZI OSB
 ANKARA / TÜRKİYE
 P: +90 312 286 2000 - F: +90 312 286 2888
 www.mtasistem.com.tr - info@mtasistem.com

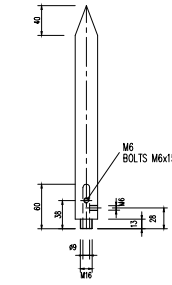
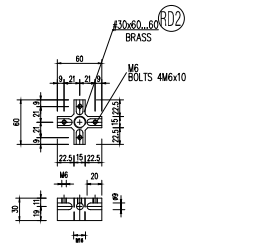
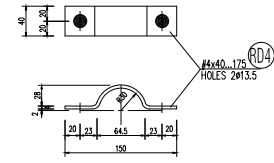
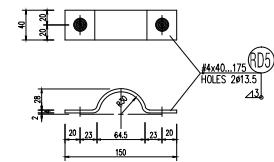
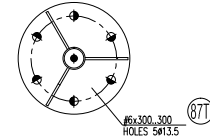
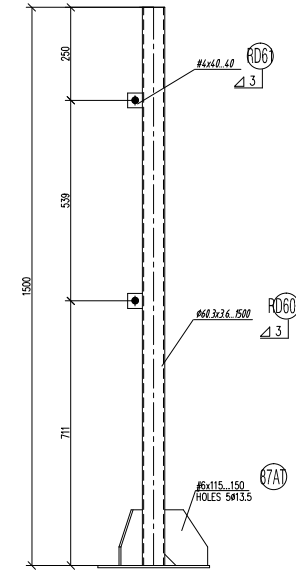
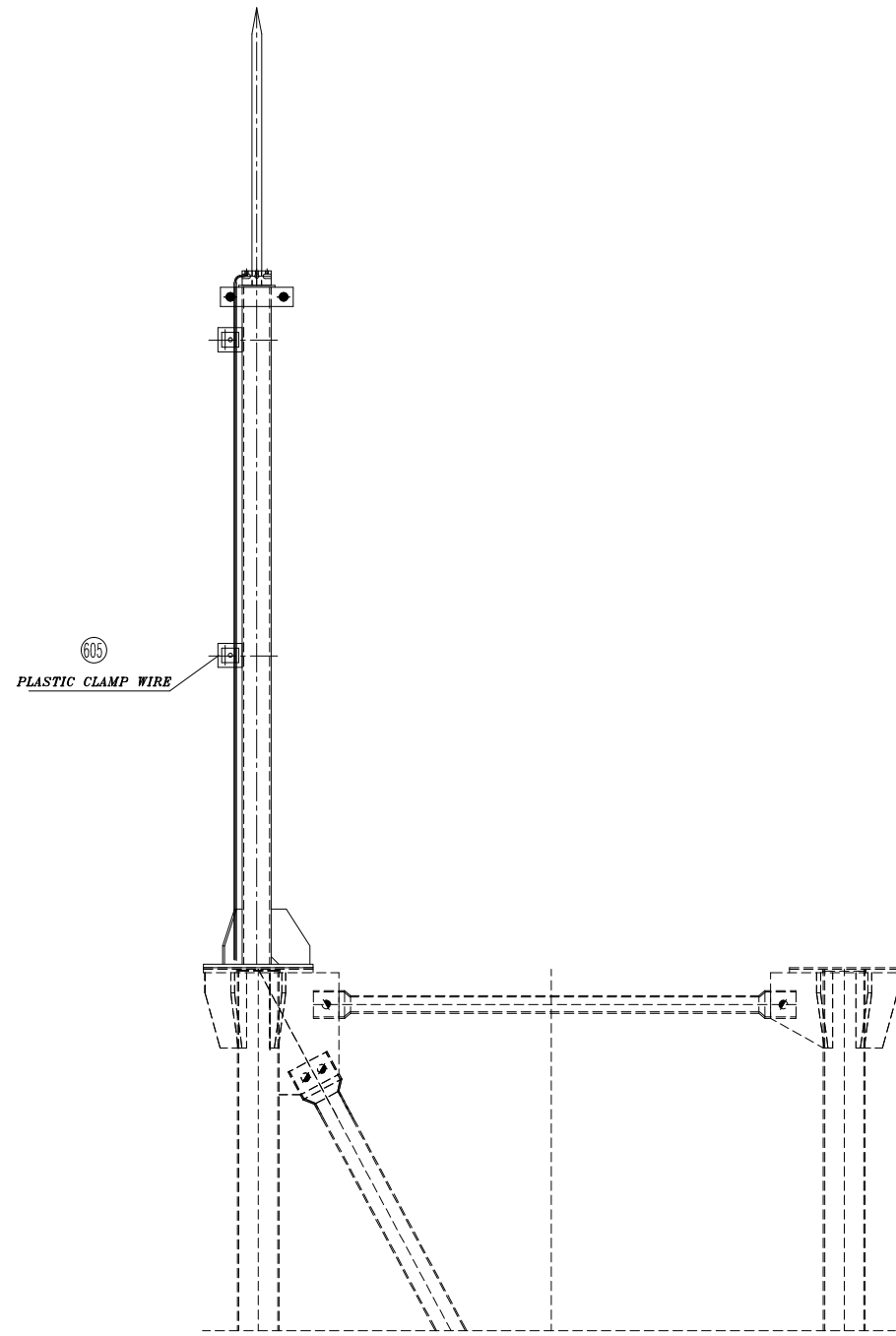

POSE	MATERIAL	WIDTH	LENGTH	QUALITY	PIECE	TOTAL PIECE
MS 1-RD 4	LIGHTNING ROD MBUD-KBD	0	0		1	1.00
	PL4	40	175	S235JR	1	1.00
ÇAP 20x1500mm PRTN. ÇUB. SOM.BAK.M16		0	0		1	
60x60x30mm M16 PRINC BAG.ISTAVROZU		0	0		1	
PARATON.MS 1P-WELD 87T		0	0		1	
MS 1-RD60K	PWD60.3X3.65	0	1,500.00	S235JR	1	
MS 1P-87AT	PL6	150	115	S235JR	3	
MS 1-RD6 1	PL4	40	40	S235JR	2	
MS 1P-87T	PL6	300	300	S235JR	1	
MS 1.KG41		0	0		1	
MS 1-RD3	PL4	75	75	S235JR	1	
MS 1-RD5	PL4	40	175	S235JR	1	
PARATON.CG08		0	0		4	
DIN933-M6X16-8.8-STD-SDG		0	0	8.8	1	
PARATON.CG07		0	0		4	
DIN933-M6X10-8.8-STD-SDG		0	0	8.8	1	
PARATON.CG06		0	0		1	
DIN933-M16X16-8.8-STD-SDG		0	0	8.8	1	
PARATON.CG05		0	0		2	
DIN933-M16X50-8.8-STD-SDG		0	0	8.8	1	
DIN934-M16-8-STD-SDG		0	0	8	1	
DIN 126-M16-STEEL-STD-SDG		0	0	STEEL	1	
DIN 127-M16-S.STEEL-STD-SDG		0	0	S.STEEL	1	

GENERAL NOTES:

- All dimensions are in mm.
- All members with "H" letter are of high tensile steel (S355JR)
- All members without "H" letter are of standart steel (S235JR)
- All bolts to be of high tensile steel (8.8 - ISO 898/90)
- Bolts DIN 931 , Plain Washers DIN 126. Spring Washers DIN 127
- All holes $\varnothing 13.5$ dia for M12 dia bolts
 - All holes $\varnothing 17.5$ dia for M16 dia bolts
 - All holes $\varnothing 21.5$ dia for M20 dia bolts
- All steel members will be hot-dip galvanized as per (ASTM-A-123)
- All fasteners will be hot galvanized as per. (ASTM-A-153)

REVIZYON REVISION	B			
	A			
PROJE ADI PROJECT	LIGHTNING ROD-1500			
 MTS - MİTAS TELEKOM SİSTEM SANAYİ TİCARET A.Ş. ESKİ DÜZÜNKAR YOLU NO:213 SAĞ YANINDA ANKARA / TÜRKİYE P: +90 312 286 2000 F: +90 312 286 2009 www.mtas.com.tr info@mtas.com.tr	HAZIRLAYAN DESIGNED BY	CİZEN DRAWN BY	KONTROL CHECKED BY	ONAY APPROVED BY
	H.J.SIK	H.J.SIK	MYLDIZ	S.ARICA
	ÖLÇEK SCALE	TARİH DATE	PAFTA NO DRAWING NO	REV. 0
	NTS	11.02.2016	PR -1B	